

Ambu® Baby R Resuscitator

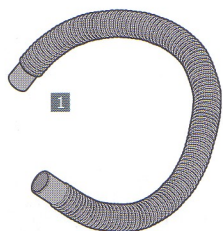

ACCESSORIES

	CAT. NO.
2 Oxygen reservoir tube, 250 mm	288 000 510
3 Paedi valve with pressure limitation valve, 40 cm H ₂ O	000 110 000
4 Paedi valve, ISO, 15 mm inlet, complet	000 101 000
5 PEEP valve 10, for baby resuscitator, 18 mm	000 138 000
6 Spiral hose for O ₂ Reservoir, EPDM rubber	209 000 508

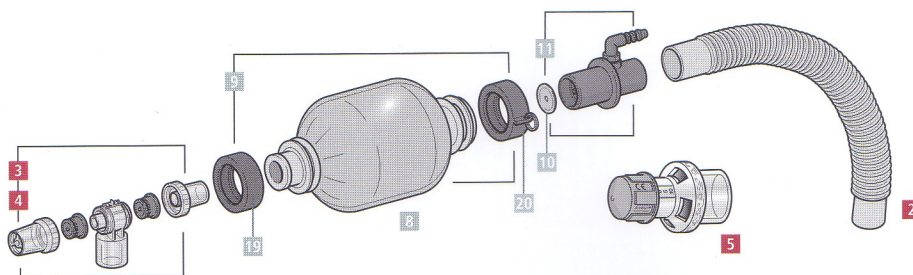
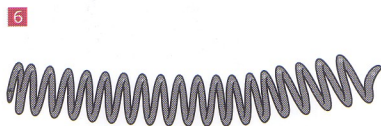

SPARE PARTS

	CAT. NO.
8 Outer cover	083 000 503
9 Self-inflating bag, complete with out valve and mask	083 000 701
10 Inlet membrane	083 000 504
11 Combined air/oxygen inlet	083 000 505
18 Extension tube, 600 mm and 15 mm connection (ISO)	059 000 501
19 Wide black support ring	083 000 501
20 Black support ring with ear	083 000 502